



**Lacquer - a matter**

**of confidence**

The lacquer used by us had to undergo countless tests before it was deemed suitable and worthy to embellish and protect the Volkswagen.

Lacquers, too, are "spare parts".



**Genuine VW Spare Parts rigidly factory inspected**

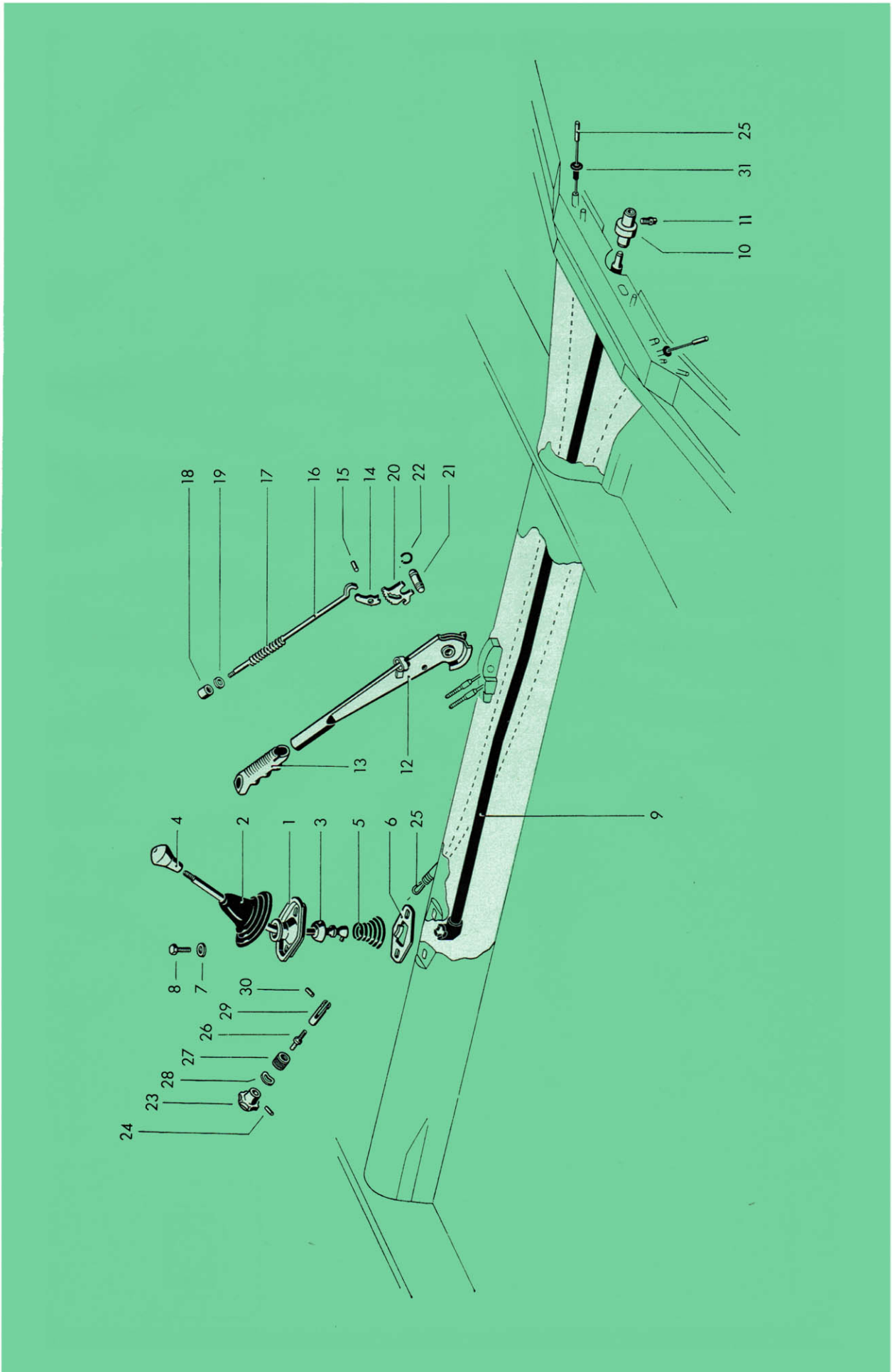

illustration 22

Key No.	Part No.	Description	Quantity	Type and model
<b>HAND LEVER SYSTEM</b>				
1	311 711 105	Ball housing – Gearshift lever .....	1	
2	311 711 115 OP	Rubber boot anthracite – Gearshift lever .....	1	
1/61	– 311 711 115 OM	Rubber boot satin blue – Gearshift lever .....	1	343, 345
1/61	– 311 711 115 OA	Rubber boot malachite green – Gearshift lever ..	1	343, 345
7/62	– 311 711 115 OS	Rubber boot grey/black – Gearshift lever .....	1	343, 345
3	311 711 121	Gearshift lever .....	1	311-314, 361-364
7/62	– 341 711 121	Gearshift lever .....	1	343, 345
4	311 711 141	Knob – Gearshift lever .....	1	
5	311 711 145	Spring – Gearshift lever .....	1	
6	311 711 149	Stop – Gearshift lever .....	1	
7	111 821 149 A	Spring washer 8.1×22 .....	2	
8	N 10 240 2	Bolt, hex. head M 8×20 DIN 933 galvanized ....	2	
9	311 711 155	Gearshift rod .....	1	
2/61	10 311 711 175	Coupling – Gearshift rod .....	1	
11	111 711 189	Screw – Gearshift rod coupling .....	2	
12	113 711 305	Lever – Hand brake .....	1	
1/61	13 311 711 327	Handle – Hand brake lever .....	1	
14	111 711 321	Pawl – Hand brake .....	1	
15	111 711 323	Pin – Hand brake pawl .....	1	
16	111 711 325	Rod – Hand brake pawl .....	1	
17	111 711 329	Spring – Pawl rod .....	1	
18	311 711 333	Release button – Hand brake lever .....	1	
19	111 711 335	Rubber washer – Hand brake lever .....	1	
1/61	– 311 711 337	Retainer – Hand brake lever grip .....	1	

Key No.	Part No.	Description	Quantity	Type and model
20	211 711 339	Ratchet – Hand brake .....	1	
21	113 711 341	Pin 14×36 – Hand brake lever .....	1	
22	N 12 460 1	Circlip 14 DIN 9045 .....	2	
12/63 23	141 711 621 0F	Knob silver beige – Heating control cable .....	1	
24	N 13 328 1	Pin 3×20 DIN 1481 .....	1	
25	311 711 629	Cable – Heating control (length 2880 mm) .....	1	
26	311 711 671	Spindle – Heating control cable .....	1	
27	111 711 675	Cap – Heating control cable .....	1	
28	111 711 677	Spring washer 10.5×18 .....	1	
29	311 711 681	Clevis – Heating control cable .....	1	
30	N 13 216 1	Cable pin 4×14 DIN 7 .....	1	
31	111 711 691	Plug .....	2	