

The Genuine Article is recognised by the pattern.

A kilt by its plaid and a package of Genuine VW Parts by the VW pattern on it and the gummed band around it with our parts sign. This symbol of authenticity ought to be put before the customer as often as possible in a parts display in the show-room window – in the showcases, in sales and waiting rooms and in the bin units.



Genuine VW Parts rigidly factory inspected

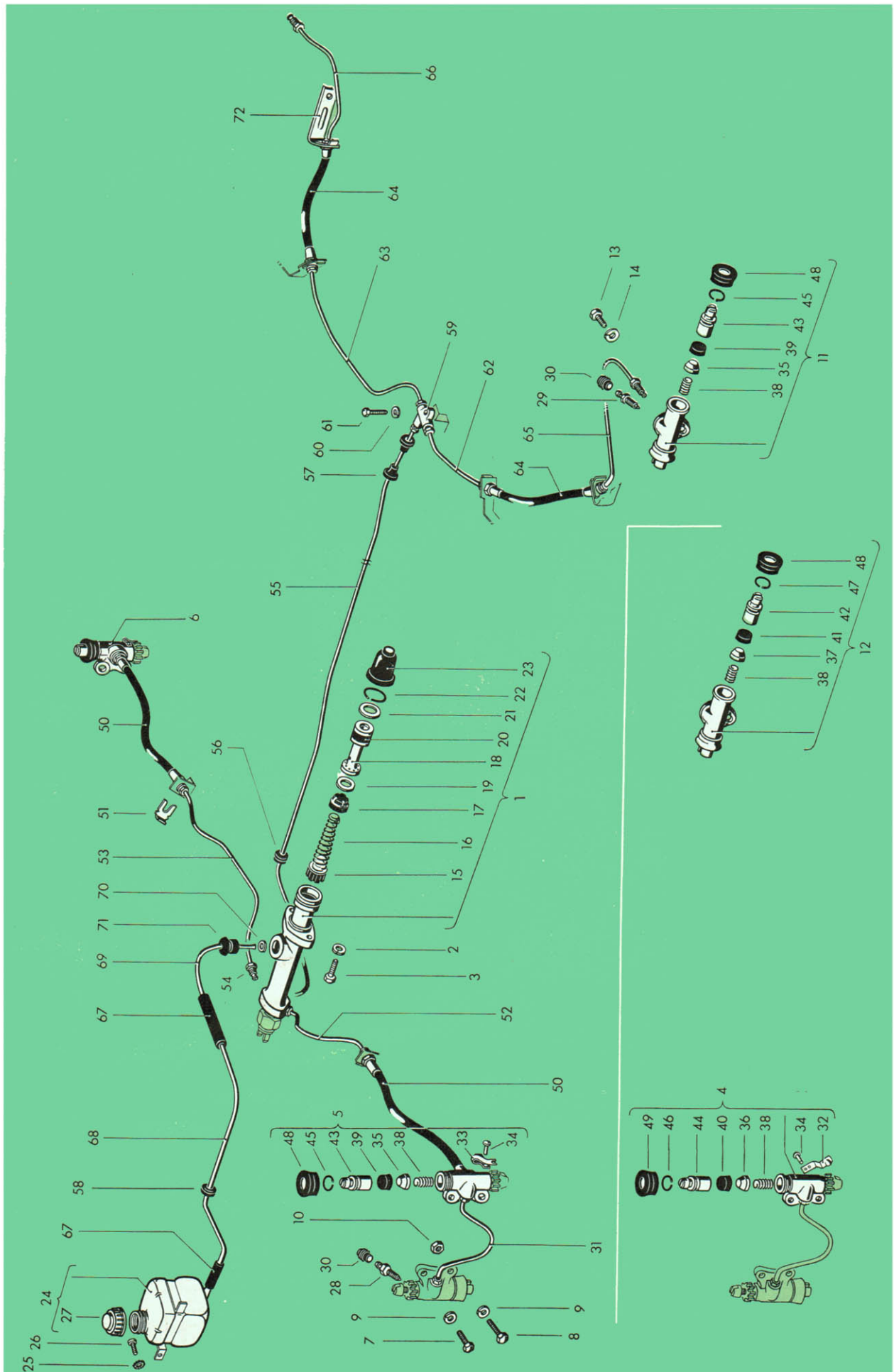

illustration 20

Key No.	Part No.	Description	Quantity	Type and model
BRAKE CYLINDERS AND LINES				
3/62	1	311 611 021 A Brake master cylinder 20.64	1	
	2	N 12 008 2 Lock washer B 8 DIN 127 galvanized	2	
	3	N 10 240 1 Bolt, hex. head M 8×20 DIN 933	2	
	4	311 611 061 Cylinder 20.64 – Front wheel brake, left	2	311, 312, 343
		up to Chassis No. 27 849		
3/62	5	311 611 061 A Cylinder 22.2 – Front wheel brake, left	2	361
		up to Chassis No. 27 849	2	
		from Chassis No. 27 850		
	-	311 611 062 Cylinder 20.64 – Front wheel brake, right	2	311, 312, 343
		up to Chassis No. 27 849		
3/62	6	311 611 062 A Cylinder 22.2 – Front wheel brake, right	2	361
		up to Chassis No. 27 849	2	
		from Chassis No. 27 850		
	7	N 10 070 1 Bolt, hex. head M 10×1×25 DIN 70 614	2	
1/61	8	N 10 071 1 Bolt, hex. head M 10×1×60 DIN 70 614	2	
	9	N 12 011 1 Lock washer A 10 DIN 127	4	
2/61	10	N 11 137 1 Nut, hex. M 10×1 DIN 70 615	2	
1/61	-	113 611 057 B Cylinder 22.2 – Rear wheel brake	2	311-314, 343, 361, 362
		up to Chassis No. July 1962		
7/62	11	311 611 067 Cylinder 22.2 – Rear wheel brake	2	311-314, 341, 343, 345
		from Chassis No. August 1962		351, 352
2/61	-	361 611 069 Cylinder 25.4 – Rear wheel brake	2	361, 362
		up to Chassis No. July 1962		
7/62	12	361 611 069 B Cylinder 25.4 – Rear wheel brake	2	361-364
		from Chassis No. August 1962		
	13	N 10 238 4 Bolt, hex. head M 8×15 DIN 933	2	
	14	N 12 008 2 Lock washer B 8 DIN 127 galvanized	2	
	15	113 611 127 B Check valve – Brake master cylinder	1	
	-	113 611 143 Piston return spring – Brake master cylinder	1	311, 312, 343
		up to Chassis No. 27 849		
3/62	16	311 611 143 A Piston return spring –	1	
		Brake master cylinder 311 611 021 A		
	17	311 611 155 A Main cup – Brake master cylinder	1	
	-	311 611 165 A Piston – Brake master cylinder	1	311, 312, 343
		up to Chassis No. 27 849		

Key No.	Part No.	Description	Quantity	Type and model	
3/62	18	311 611 165 B	Piston – Brake master cylinder 311 611 021 A ...	1	
	19	311 611 167 A	Washer – Brake master cylinder	1	
	20	311 611 173 A	Secondary cup – Brake master cylinder	1	
	21	113 611 179	Stop plate – Brake master cylinder	1	
	22	113 611 185	Lock ring	1	
	23	113 611 195	Boot – Brake master cylinder	1	
7/62	24	113 611 301 F	Reservoir – Brake master cylinder	1	
	25	N 12 127 2	Shake-proof washer A 6.4 DIN 6797 galvanized ...	1	
	26	N 14 140 1	Screw, fillister head AM 6×15 DIN 7985 galvanized	1	
2/61	27	113 611 351	Screw cap – Reservoir	1	
2/61	-	113 611 363	Seal – Screw cap	1	
	-	113 611 373	Plug – Reservoir 113 611 301 B	1	
	28	211 611 475	Bleeder valve M 10 – Wheel brake cylinder front	2	
	29	211 611 477	Bleeder valve M 6 – Wheel brake cylinder rear ..	2	
	30	211 611 483	Dust cap – Bleeder valve	4	
	31	311 611 505	Bridge pipe	2	
	32	311 611 591	Leaf spring – Wheel brake cylinder, front left	2	
7/62	33	311 611 591 A	Leaf spring – Wheel brake cylinder, front	4	
	-	311 611 592	Leaf spring – Wheel brake cylinder, front right	2	
	34	N 15 188 1	Grooved pin 2.6×4 DIN 1476 galvanized	8	
	35	211 611 607	Cup expander – Wheel brake cylinder 22.2	4	311, 312, 343, 361
			up to Chassis No. 27 849	8	
			from Chassis No. 27 850		
	36	311 611 607	Cup expander – Wheel brake cylinder 20.64	4	311, 312, 343
			up to Chassis No. 27 849		
2/61	37	361 611 607	Cup expander – Wheel brake cylinder 25.4	4	361-364

Key No.	Part No.	Description	Quantity	Type and model	
	38	113 611 615	Spring – Cup expander	6	
	39	211 611 627	Cup – Wheel brake cylinder 22.2	4	311, 312, 343, 361
		up to Chassis No. 27 849 from Chassis No. 27 850	8		
	40	311 611 627	Cup – Wheel brake cylinder 20.64	4	311, 312, 343
10/62	–	311 611 637	Cup – Wheel brake cylinder 22.2	×	
		(see Workshop Bulletin B-17)			
2/61	41	361 611 639	Cup – Wheel brake cylinder 25.4	4	361-364
10/62	–	361 611 639 A	Cup – Wheel brake cylinder 25.4	×	
		(see Workshop Bulletin B-17)			
2/61	42	361 611 655	Piston – Wheel brake cylinder 25.4	4	361-364
10/62	–	361 611 655 A	Piston – Wheel brake cylinder 25.4	×	
		(see Workshop Bulletin B-17)			
	43	113 611 657 A	Piston – Wheel brake cylinder 22.2	4	311, 312, 343, 361
		up to Chassis No. 27 849 from Chassis No. 27 850	8		
	44	311 611 657	Piston – Wheel brake cylinder 20.64	4	311, 312, 343
10/62	–	311 611 657 B	Piston – Wheel brake cylinder 22.2	×	
		(see Workshop Bulletin B-17)			
	45	113 611 693	Circlip – Piston 22.2	4	311, 312, 343, 361
		up to Chassis No. 27 849 from Chassis No. 27 850	8		
	46	311 611 693	Circlip – Piston 20.64	4	311, 312, 343
2/61	47	361 611 693	Circlip – Piston 25.4	4	361-364
	48	113 611 695 E	Boot – Wheel brake cylinder 22.2 and 25.4	4	311, 312, 343, 361
		up to Chassis No. 27 849 from Chassis No. 27 850	8		
13/63	49	113 611 695 D	Boot – Wheel brake cylinder 20.64	4	311, 312, 343
	–	311 611 701	Hose – Front brake (length 415 mm)	2	
		up to Chassis No. 36 000			
6/62	50	311 611 701 A	Hose – Front brake (length 380 mm)	2	
		from Chassis No. 36 001			
	51	113 611 715 A	Bracket – Brake hose	6	
	–	311 611 723	Brake line front (length 230 mm)	1	
		up to Chassis No. 36 000			
6/62	52	311 611 723 A	Brake line front (length 262 mm)	1	
		from Chassis No. 36 001			

735 314 20

Printed in Germany

Supplement 13/63
Type 3

Key No.	Part No.	Description	Quantity	Type and model
-	311 611 724	Brake line front (length 490 mm) up to Chassis No. 36 000	1	
6/62	53 311 611 724 A	Brake line front (length 542 mm) from Chassis No. 36 001	1	
	54 113 611 731	Union nut	X	
	55 311 611 741	Brake line from master cylinder to T-piece (LHD)	1	
2/61	- 312 611 741	Brake line from master cylinder to T-piece (RHD)	1	
	56 211 611 751	Grommet for brake line through frame, front	1	
	57 311 941 189	Grommet for brake line through frame, rear	2	
	58 311 611 753	Grommet for line between reservoir and master cylinder	1	
	59 113 611 755	T-piece - Brake lines	1	
	60 N 12 006 2	Lock washer B 6 DIN 127 galvanized	1	
	61 N 10 222 1	Bolt, hex. head M 6×22 DIN 933	1	
	62 311 611 763	Brake line between T-piece and brake hose, rear, left (length 165 mm)	1	
	63 311 611 764	Brake line between T-piece and brake hose, rear, right (length 670 mm)	1	
	64 113 611 775	Hose - Rear brake (length 270 mm)	2	
	65 311 611 781	Line (length 280 mm) - Rear brake, left	1	
	66 311 611 782	Line (length 280 mm) - Rear brake, right	1	
	67 113 611 801 A	Connecting hose - Line between reservoir and brake master cylinder	2	
	68 311 611 805	Line - Reservoir (LHD)	1	311, 313, 361, 363
2/61	- 312 611 805	Line - Reservoir (RHD)	1	312, 314, 362, 364
	69 311 611 807	Line - Brake master cylinder to reservoir	1	
	70 113 611 811	Washer 3.5×14 - Plug	1	
	71 113 611 817	Plug - Master cylinder	1	
	72 311 611 843	Clip - Brake hose, rear	2	