



***The old man with the beard —***

What was his name again?

Have you ever counted to see how many of your customers you know personally? The customers pay your salary. Keep thinking of that, and remember their names.



***Genuine VW Spare Parts rigidly factory inspected***

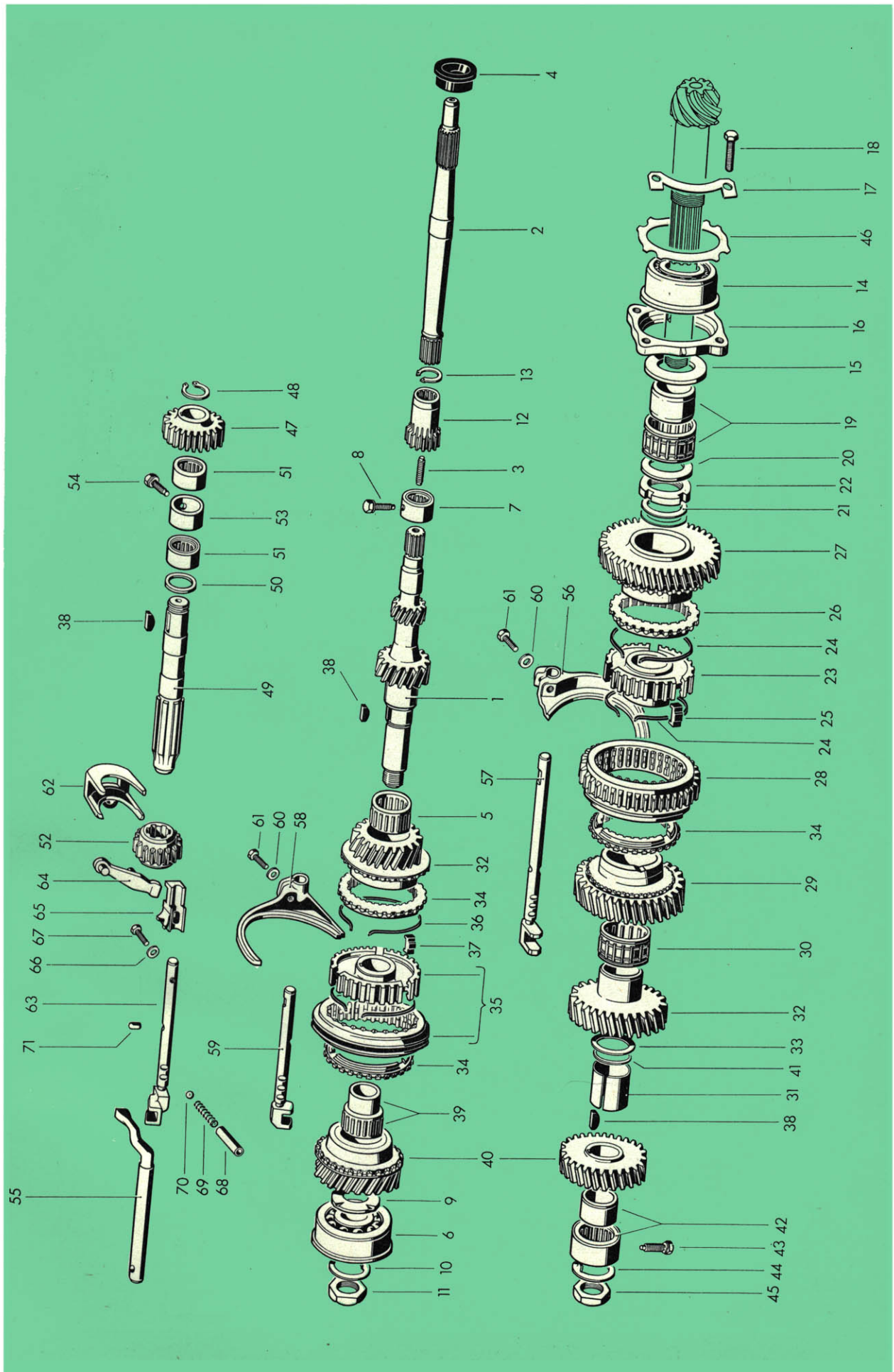

illustration 14

Key No.	Part No.	Description	Quantity	Type and model
<b>GEARS, SHAFTS</b>				
1	113 311 101	Main drive shaft, front .....	1	
2	113 311 105	Main drive shaft, rear .....	1	
3	113 311 109	Stud for main drive shaft connection .....	1	
15/63	111 307 113 A	Oil seal – Main drive shaft .....	1	
5	113 311 115	Needle bearing (3 <sup>rd</sup> gear) – Main drive shaft ....	1	
6	113 311 123	Ball bearing – Main drive shaft .....	1	
7	113 311 125	Needle bearing – Main drive shaft .....	1	
8	113 311 141	Lock bolt for needle bearing on main drive shaft	1	
9	113 311 151	Thrust washer for 4 <sup>th</sup> gear on main drive shaft ...	1	
10	113 309 381 A	Lock plate – Main drive shaft .....	1	
11	113 309 385	Nut, hex. M 22×1.5 – Main drive shaft .....	1	
12	113 311 161	Reverse gear on main drive shaft .....	1	
13	N 12 419 1	Lockring 19×1.2 DIN 471 – Reverse gear .....	1	
14	113 311 219	Ball bearing – Drive pinion .....	1	
15	113 311 221	Thrust washer between 1 <sup>st</sup> gear and ball bearing	1	
16	113 311 223	Retainer for ball bearing .....	1	
17	113 311 225	Lock plate – Retainer .....	2	
18	N 10 022 1	Bolt, hex. head M 10×35 DIN 70 613 .....	4	
19	113 311 227	Needle bearing (1 <sup>st</sup> gear) – Drive pinion .....	1	
20	113 311 229	Thrust washer between needle bearing .....	1	
		and round nut		

735 316 20

Printed in Germany

Type 3 Supplement 15/63

Key No.	Part No.	Description	Quantity	Type and model	
21	113 311 231	Shim 0.10 mm – Clutch gear (1 <sup>st</sup> speed) .....	×		
–	113 311 232	Shim 0.15 mm – Clutch gear (1 <sup>st</sup> speed) .....	×		
–	113 311 233	Shim 0.20 mm – Clutch gear (1 <sup>st</sup> speed) .....	×		
–	113 311 234	Shim 0.25 mm – Clutch gear (1 <sup>st</sup> speed) .....	×		
–	113 311 235	Shim 0.30 mm – Clutch gear (1 <sup>st</sup> speed) .....	×		
–	113 311 236	Shim 0.40 mm – Clutch gear (1 <sup>st</sup> speed) .....	×		
22	113 311 237	Round nut for drive pinion .....	1		
23	113 311 243	Clutch gear – 1 <sup>st</sup> and 2 <sup>nd</sup> speeds .....	1		
24	113 309 311	Snap ring – Shifting plate .....	2		
25	113 309 313	Shifting plate – 1 <sup>st</sup> and 2 <sup>nd</sup> gears .....	3		
26	113 311 247	Synchronizer stop ring – 1 <sup>st</sup> speed (3 mm shoulder) up to Chassis No. 5 827	1		
5/62	– 113 311 247 A	Synchronizer stop ring – 1 <sup>st</sup> speed (5 mm shoulder) from Chassis No. 5 828	1		
27	113 311 251	Gear (1 <sup>st</sup> speed) on drive pinion .....	1		
15/63	28	311 311 255	Operating sleeve – 1 <sup>st</sup> and 2 <sup>nd</sup> speeds .....	1	
29	113 311 261	Gear (2 <sup>nd</sup> speed) on drive pinion .....	1		
30	113 311 265	Needle bearing (2 <sup>nd</sup> gear) on drive pinion .....	1		
31	113 311 271 A	Spacer sleeve for drive pinion .....	1		
32	113 311 275	Gear train (3 <sup>rd</sup> speed) .....	1		
33	113 311 281	Concave washer between .....	1		
		3 <sup>rd</sup> and 4 <sup>th</sup> gears on drive pinion			
34	113 311 295	Synchronizer stop ring – 2 <sup>nd</sup> , 3 <sup>rd</sup> and 4 <sup>th</sup> speeds (3 mm shoulder) up to Chassis No. 5 827	3		
5/62	– 113 311 295 A	Synchronizer stop ring – 2 <sup>nd</sup> , 3 <sup>rd</sup> and 4 <sup>th</sup> speeds (5 mm shoulder) from Chassis No. 5 828	3		

Key No.	Part No.	Description	Quantity	Type and model
7/62 35	311 311 307 A	Clutch gear with operating sleeve ..... for 3 <sup>rd</sup> and 4 <sup>th</sup> gears	1	
36	113 309 311	Snap ring – Shifting plate .....	2	
37	113 309 313	Shifting plate – 3 <sup>rd</sup> and 4 <sup>th</sup> gears .....	3	
38	113 311 321	Woodruff key 5×7.5 .....	×	
-	113 311 323	Woodruff key 5.03×7.5 .....	×	
39	113 311 325	Needle bearing (4 <sup>th</sup> gear) – Main drive shaft ....	1	
40	113 311 341	Gear train (4 <sup>th</sup> speed) .....	1	
41	113 311 361	Shim 0.15 mm – Concave washer .....	×	
-	113 311 362	Shim 0.20 mm – Concave washer .....	×	
-	113 311 363	Shim 0.25 mm – Concave washer .....	×	
-	113 311 364	Shim 0.30 mm – Concave washer .....	×	
-	113 311 365	Shim 0.40 mm – Concave washer .....	×	
-	113 311 366	Shim 0.60 mm – Concave washer .....	×	
-	113 311 367	Shim 0.80 mm – Concave washer .....	×	
-	113 311 368	Shim 1.00 mm – Concave washer .....	×	
-	113 311 369	Shim 1.20 mm – Concave washer .....	×	
42	113 311 375	Needle bearing – Drive pinion .....	1	
43	113 311 141	Lock bolt for needle bearing on drive pinion ....	1	
44	113 309 381 A	Lock plate – Drive pinion .....	1	
45	113 309 385	Nut, hex. M 22×1.5 – Drive pinion .....	1	

Key No.	Part No.	Description	Quantity	Type and model
46	113 311 391	Shim 0.15 mm – Drive pinion .....	×	
–	113 311 392	Shim 0.20 mm – Drive pinion .....	×	
–	113 311 393	Shim 0.30 mm – Drive pinion .....	×	
–	113 311 394	Shim 0.40 mm – Drive pinion .....	×	
–	113 311 395	Shim 0.50 mm – Drive pinion .....	×	
–	113 311 396	Shim 0.60 mm – Drive pinion .....	×	
–	113 311 397	Shim 0.70 mm – Drive pinion .....	×	
–	113 311 398	Shim 0.80 mm – Drive pinion .....	×	
–	113 311 399	Shim 0.90 mm – Drive pinion .....	×	
–	113 311 400	Shim 1.00 mm – Drive pinion .....	×	
–	113 311 401	Shim 1.20 mm – Drive pinion .....	×	
47	113 311 507	Reverse drive gear .....	1	
48	N 12 419 1	Lockring 19×1.2 DIN 471 .....	1	
49	113 311 515	Reverse gear shaft .....	1	
50	113 311 517	Thrust washer for reverse gear shaft .....	1	
51	113 311 523	Needle bearing for reverse gear shaft .....	2	
52	113 311 531	Reverse sliding gear .....	1	
53	113 311 537	Spacer sleeve for reverse gear shaft .....	1	
54	113 311 141	Lock bolt – Spacer sleeve .....	1	
55	113 311 541 A	Transmission shift lever, inner .....	1	

Key No.	Part No.	Description	Quantity	Type and model	
56	113 311 551	Selector fork (1 <sup>st</sup> and 2 <sup>nd</sup> speed) .....	1		
57	113 311 557	Selector shaft (1 <sup>st</sup> and 2 <sup>nd</sup> speed) .....	1		
58	113 311 561	Selector fork (3 <sup>rd</sup> and 4 <sup>th</sup> speed) .....	1		
59	113 311 567	Selector shaft (3 <sup>rd</sup> and 4 <sup>th</sup> speed) .....	1		
60	N 12 241 2	Spring washer B 8×15 DIN 137 galvanized .....	2		
61	113 309 595	Bolt, hex. head M 8×25 – Selector fork .....	2		
62	113 311 571	Selector fork (reverse) .....	1		
63	113 311 577	Selector shaft (reverse) .....	1		
7/62	64	113 311 581 A	Reverse lever for reverse gear .....	1	
	65	113 311 585	Guide for reverse lever .....	1	
	66	N 12 234 1	Spring washer B 7 DIN 137 .....	1	
	67	N 10 316 1	Bolt, hex. head M 7×22 DIN 931 .....	1	
8/62	–	113 311 599	Retaining plug – Detent ball .....	3	
	68	111 307 621	Sleeve – Detent ball .....	3	
	69	111 307 625	Spring – Detent ball .....	3	
	70	111 307 627	Detent ball – Selector shaft .....	3	
	71	111 307 629	Plunger – Gear lock .....	2	

735 309 20

Type 3 Supplement 8/62 Printed in Germany

Key No.	Part No.	Description	Quantity	Type and model