

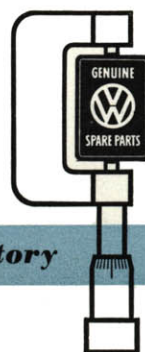

The Genuine Article is recognised by the pattern.

A kilt by its plaid and a package of Genuine VW Parts by the VW pattern on it and the gummed band around it with our parts sign. This symbol of authenticity ought to be put before the customer as often as possible in a parts display in the show-room window – in the showcases, in sales and waiting rooms and in the bin units.



Genuine VW Parts rigidly factory inspected

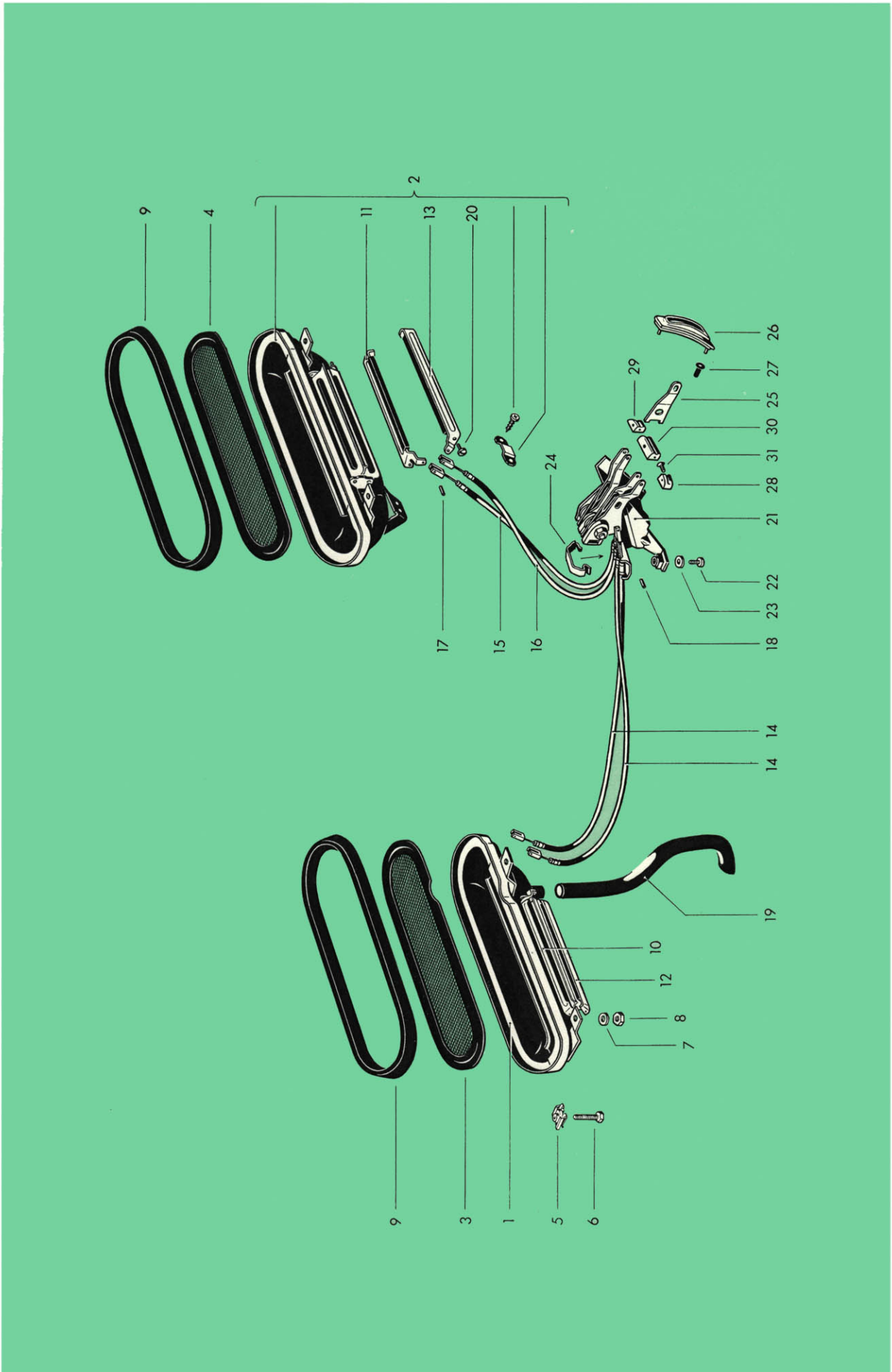

Illustration 12

Key No.	Part No.	Description	Quantity	Type and model	
FRESH AIR CONTROL					
1	311 259 103	Fresh air control box, left	1	311-314,351,352,361-364	
2	311 259 104	Fresh air control box, right	1	311-314,351,352,361-364	
3	311 259 141 A	Grille - Fresh air control box, left	1	311-314,351,352,361-364	
4	311 259 142 A	Grille - Fresh air control box, right	1	311-314,351,352,361-364	
5	311 259 145	Captive nut M 6 - Fresh air control box mounting	4	311-314,351,352,361-364	
6	N 10 218 1	Bolt, hex. head M 6×25 DIN 933	4	311-314,351,352,361-364	
7	N 11 524 1	Washer A 6.4 DIN 125	4	311-314,351,352,361-364	
8	N 11 006 2	Nut, hex. M 6 DIN 934 galvanized	4	311-314,351,352,361-364	
9	311 259 149	Seal - Fresh air control box	2		
10	311 259 151 A	Flap, upper - Fresh air control box, left	1	311-314,351,352,361-364	
11	311 259 152	Flap, upper - Fresh air control box, right	1	311-314,351,352,361-364	
12	311 259 159	Flap, lower - Fresh air control box, left	1	311-314,351,352,361-364	
13	311 259 160	Flap, lower - Fresh air control box, right	1	311-314,351,352,361-364	
-	311 259 175 A	Cable, upper, left 580 mm - Fresh air control up to Chassis No. 17 645	1	311, 312, 361	
5/62	14	311 259 175 B	Cable, upper and lower, left 477 mm -	2	311-314,351,352,361-364
			Fresh air control from Chassis No. 17 646		
-	311 259 176 A	Cable, upper, right 430 mm - Fresh air control .. up to Chassis No. 17 645	1	311, 312, 361	
5/62	15	311 259 176 B	Cable, upper, right 280 mm - Fresh air control .. from Chassis No. 17 646	1	311-314,351,352,361-364
-	311 259 177 A	Cable, lower, left 470 mm - Fresh air control ... up to Chassis No. 17 645	1	311, 312, 361	
-	311 259 178 A	Cable, lower, right 315 mm - Fresh air control ... up to Chassis No. 17 645	1	311, 312, 361	
5/62	16	311 259 178 B	Cable, lower, right 272 mm - Fresh air control ... from Chassis No. 17 646	1	311-314,351,352,361-364
17	N 13 330 1	Pin 2.5×5 DIN 1481 galvanized	4	311-314,351,352,361-364	

735 311 20

Printed in Germany

Type 3 Supplement 10/62

Key No.	Part No.	Description	Quantity	Type and model	
	18	N 13 346 1	Pin 2×5 DIN 1481	4	311-314,351,352,361-364
10/62	19	311 259 199 B	Water drain hose	2	311-314,351,352,361-364
	20	311 259 225	Screw - Fresh air flap	4	311-314,351,352,361-364
	21	311 259 305	Fresh air regulator (LHD)	1	311, 313, 351, 361, 363
2/61	-	312 259 305	Fresh air regulator (RHD)	1	312, 314, 352, 362, 364
	22	N 14 140 1	Screw, fillister head AM 6×15 DIN 7985 galvanized	2	311-314,351,352,361-364
	23	N 12 226 2	Spring washer B 6 DIN 137 galvanized	2	311-314,351,352,361-364
5/62	24	311 259 325	Clip - Fresh air control cables from Chassis No. 17 646	1	311-314,351,352,361-364
	25	311 259 345	Leaf spring - Fresh air regulator	4	311-314,351,352,361-364
	26	311 259 375	Escutcheon - Fresh air regulator	2	311-314,351,352,361-364
	27	113 853 615	Gasket - Escutcheon	4	311-314,351,352,361-364
5/62	-	311 259 379	Button outer - Fresh air control (marked with an arrow)	2	311, 312, 361
5/62	28	311 259 379 A	Button outer left - Fresh air control (marked with a dot)	1	311-314,351,352,361-364
5/62	29	311 259 380 A	Button outer right - Fresh air control (marked with a dot)	1	311-314,351,352,361-364
5/62	30	311 259 383 B	Button inner - Fresh air control (marked with a dot)	1	311-314,351,352,361-364
	31	N 10 904 3	Screw, countersunk head AM 3.5×6 DIN 63 high-polish galvanized	4	311-314,351,352,361-364